

MEADRAIN® Supreme System S 2000

Technical data

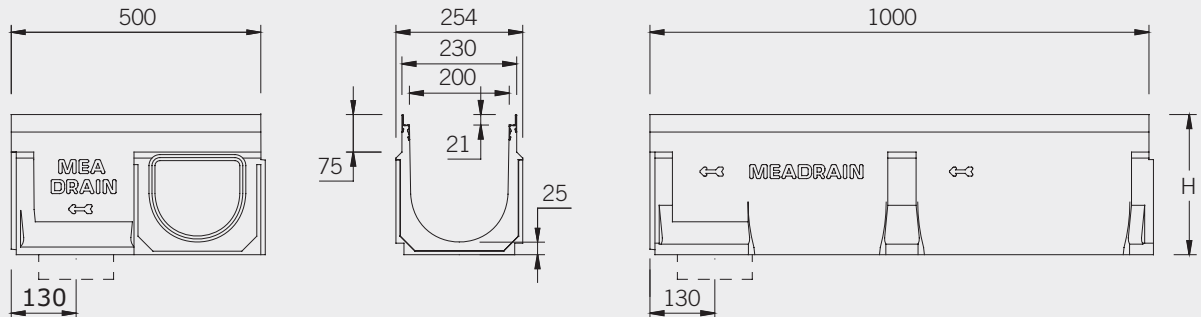

Material properties

Channel body and channel component

- ◆ Polymer concrete based on polyester resin
- ◆ Compression resistance: $\geq 90 \text{ N/mm}^2$
- ◆ Flexural strength: $\geq 22 \text{ N/mm}^2$
- ◆ Water absorption: less than 0,05%
- ◆ Density: 2,1 - 2,3 kg/dm^3
- ◆ Modules of elasticity: 25-35 kN/mm^2
- ◆ Water penetration level: 0 mm
- ◆ Material structure: capillary free

Edge protection

- ◆ Stainless steel: V2A raw material number 1.43 01

Grating

- ◆ Mesh grating: galvanized steel

Description and sizes

- ◆ Drainage channel made of polymer concrete with sealable channel groove
- ◆ Integrated stainless steel edge protection
- ◆ Preformed knockouts for vertical discharge $\varnothing 160$ in a 500 mm and 1000 mm component
- ◆ Interlocking joint system for an exact fitting of the channels
- ◆ Suitable for installation of MEADRAIN Top 2000 grating covers with standard locking mechanism
- ◆ Fall type: stepped fall, without fall
- ◆ Loading classes: A 15 - C 250 to EN 1433
- ◆ Total height: 280 mm - 380 mm (see table)
- ◆ Total width: 254 mm
- ◆ Length: 500 mm and 1000 mm

Channel units overview

Channel without fall

product description	length mm	total height h1 mm	total height h2 mm	weight kg	inlet sectional area** cm ²	EDP- number 010...
S 2000.0 ¹⁾	1000	280	280	34,5	420,0	154245
S 2000.1 ¹⁾²⁾	500	280	280	17,3	420,0	154247
S 2010.0 ¹⁾	1000	330	330	40,0	520,0	154249
S 2010.1 ¹⁾²⁾	500	330	330	20,1	520,0	154251
S 2020.0 ¹⁾	1000	380	380	45,5	620,0	154253
S 2020.1 ¹⁾²⁾	500	380	380	22,8	620,0	154255

Channel with stepped fall

product description	length mm	total height h1 mm	total height h2 mm	weight kg	inlet sectional area** cm ²	EDP- number 010...
S 2000-10	1000	280	330	36,0	520,0	154257
S 2010-20	1000	330	380	42,0	620,0	154259

¹⁾ channel element suitable for connection to a vertical Ø 160 outlet connector, a silt box or an end cap with an outlet connector

²⁾ channel element suitable for corner and cross junction connection

** cross sectional area from the grating surface to the invert of the channel

Grating covers

product description	mesh width mm	length mm	width mm	weight kg	inlet sectional area cm ² /m	EDP- number 010...
mesh grating galvanized steel	20 x 30	1000	223	15,5	1570,0	152533
mesh grating galvanized steel	20 x 30	500	223	7,5	1570,0	152535
locking mechanism galvanized steel (2 pc./ 1 m.)						152213

Gully elements overview

product description	description	length mm	total height h mm	weight kg	EDP- number 010...
E 2000 SK-OT	Upper gully section, both sides closed. Preformed knockouts for breaking out, suitable for E 2000, E 2010, E 2020.	500	430	27,0	154240
SK-ZT	Middle gully section to increase total height	524	350	22,0	154709
SK-UT-short	Lower gully section "short" with connecting facility for Ø 160 ¹⁾ /200	524	310	24,0	154711
SK-UT-long	Lower gully section "long" with connecting facility for Ø 160 ¹⁾ /200	524	460	33,6	154719
Sediment bucket	Galvanized steel, for silt box 2000	524	310	24,0	154711

¹⁾ Liquid proof connection with a sealing ring is possible.

Silt box made of polymer concrete S 2000.SK

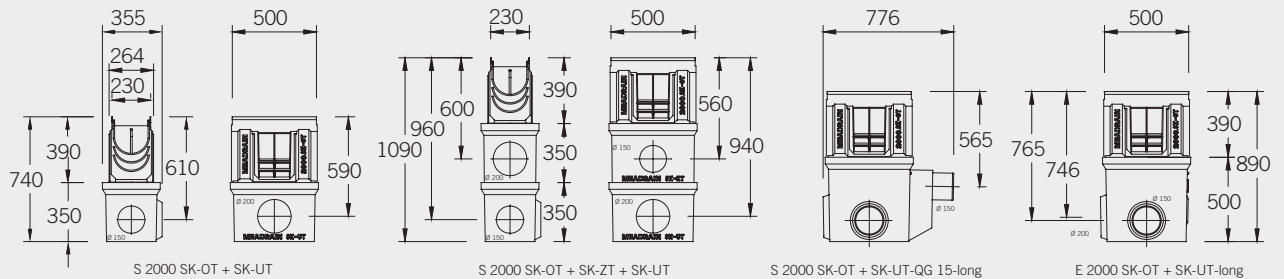

Description and sizes

- ◆ Multipart construction with multiple combination possibilities of upper, middle and lower gully
- ◆ Integrated stainless steel edge protection
- ◆ Sediment bucket of galvanized steel available as accessory
- ◆ Suitable for installation of MEADRAIN Top 2000 grating covers with standard locking mechanism
- ◆ Preformed knockouts for breaking out, making the perfect connection of channel types 2000, 2010 and 2020
- ◆ Connection facility for \varnothing 160 and \varnothing 200

Sediment bucket for silt box S 2000.SK-S

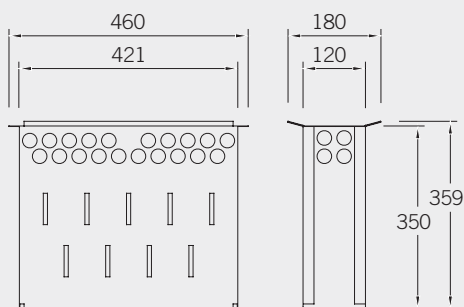

Description and sizes

- ◆ Optimized slot design for better discharge rates
- ◆ Material: galvanized steel DX 51 D 275 NA to EN 10 142

◆ EDP-number:	010154717	◆ Length:	460 mm
◆ Total height:	359 mm	◆ Weight:	2,5 kg
◆ Total width:	180 mm		

End caps for channel start and channel end S 2000.SE

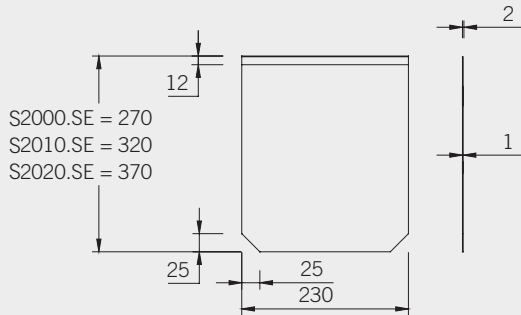

Description and sizes

◆ Material	stainless steel		
	S 2000.SE	S 2010.SE	S 2020.SE
◆ EDP-number:	010154261	010154263	010154265
◆ Total height:	270 mm	320 mm	370 mm
◆ Total width:	230 mm	230 mm	230 mm
◆ Weight:	0,6 kg	0,7 kg	0,8 kg

Installation example

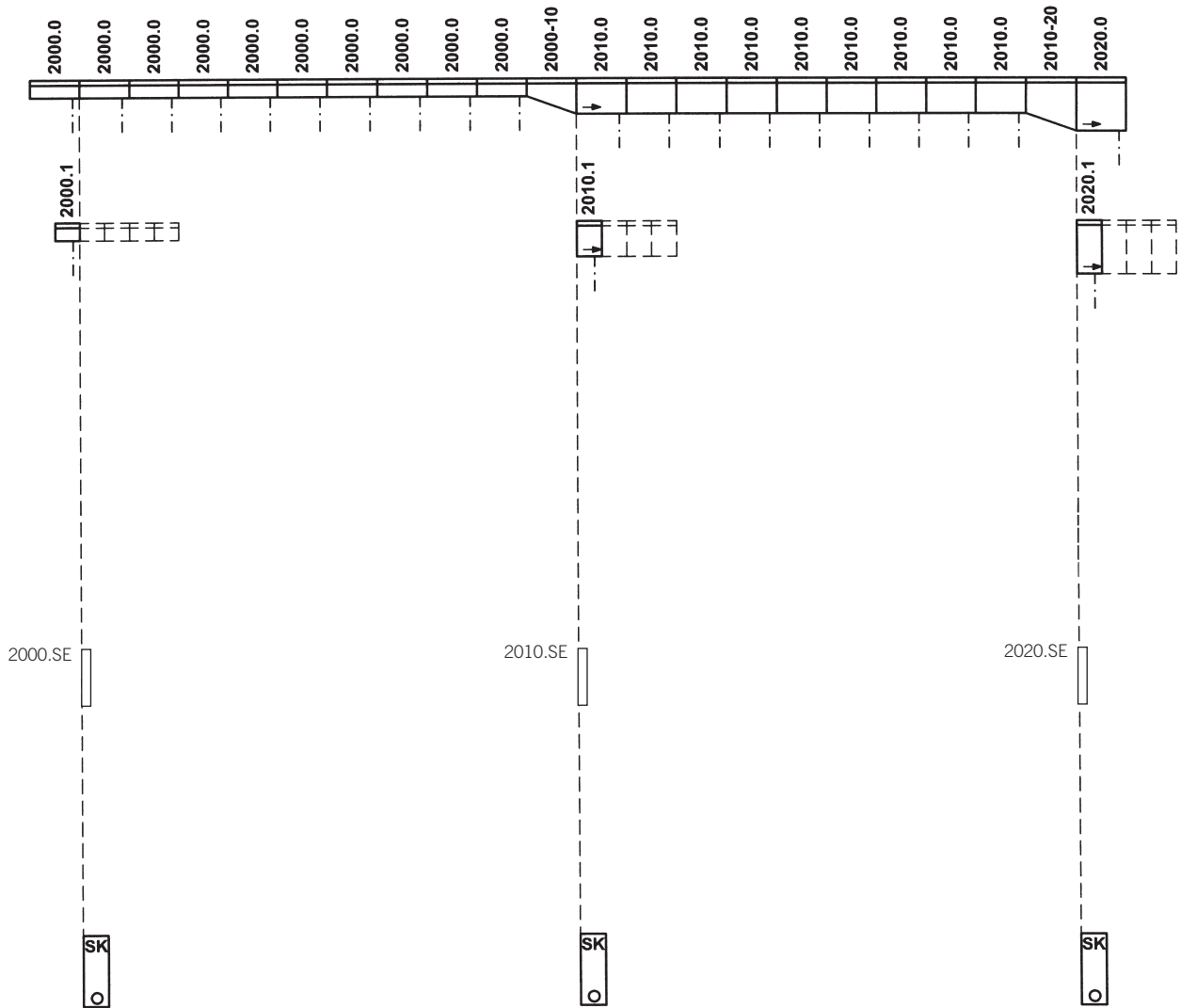

⋮ = Preformed knockouts or drilling for vertical discharge.

Supreme loading class A 15

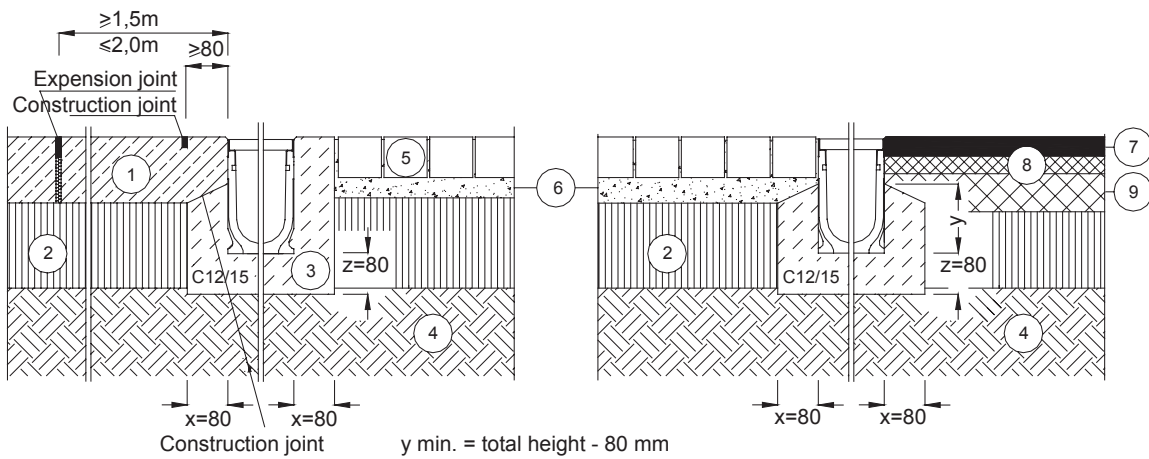

Supreme loading class B 125

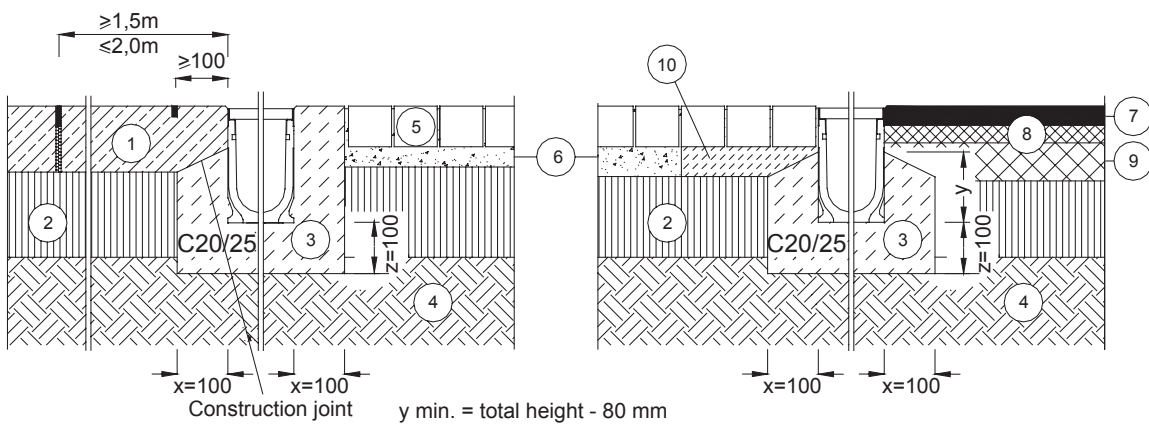

Supreme loading class C 250

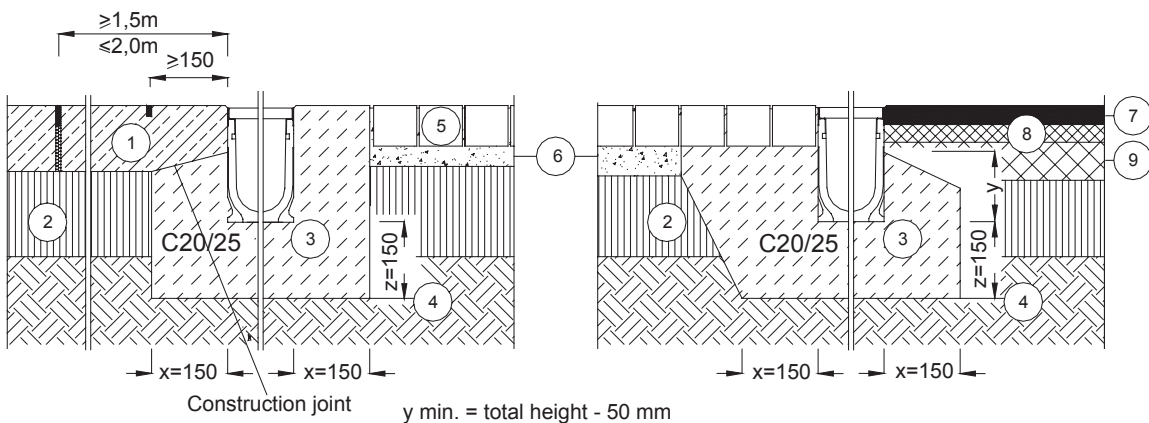

- ① concrete
- ② sub-base
- ③ concrete haunch
- ④ stabilized earth

- ⑤ block paving
- ⑥ sand layer
- ⑦ asphalt
- ⑧ base course

- ⑨ bituminous base course
- ⑩ mortar

MEA Polymer Beton B.V.
 HydroH2o
 P.O. Box 533
 3207 Port Melbourne
 Australia
 tel: (+61) 3 9673 1818
 fax: (+61) 3 9673 1800
 info@hydroh2o.com.au
 www.hydroh2o.com.au

The adjacent surfaces to the channels are to be constructed in such a way that no horizontal forces affect the channel items.